

* refers to tube end

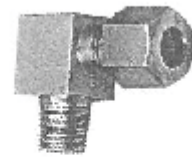

ELBOW MALE STUD BSP / METRIC - PARALLEL

S T R E S S	NOMINAL WORKING PRESSURE	TUBE O.D.	S1	S2	l2	L2	l3	i	BSP THD.		METRIC THD.		WT. Kg/100 Pieces
									G	PART NUMBER	M	PART NUMBER	
L M E D I U M	160Kg/cm ²	22	32	36	27.5	44	42	16	3/4"	LEMS 22 RP	M26x1.5	LEMS 22 MP	29.5
		28	41	41	30.5	47	48	18	1"	LEMS 28 RP	M33x2	LEMS 28 MP	46.0
	100Kg/cm ²	35	50	50	34.5	56	54	20	1 1/4"	LEMS 35 RP	M42x2	LEMS 35 MP	73.5
		42	55	60	40	63	61	22	1 1/2"	LEMS 42 RP	M48x2	LEMS 42 MP	96.7
S H E A V Y	400Kg/cm ²	20	32	36	26.5	48	42	16	3/4"	SEMS 20 RP	M27x2	SEMS 20 MP	36.4
		25	41	46	30	54	48	18	1"	SEMS 25 RP	M33x2	SEMS 25 MP	69.0
	250Kg/cm ²	30	50	50	35.5	62	54	20	1 1/4"	SEMS 30 RP	M42x2	SEMS 30 MP	89.3
		38	55	60	41	72	61	22	1 1/2"	SEMS 38 RP	M48x2	SEMS 38 MP	137.0

PART NUMBER CODE

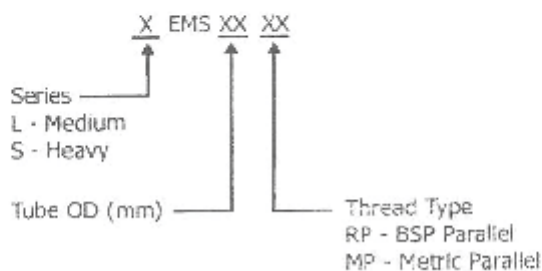

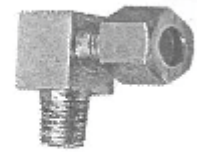
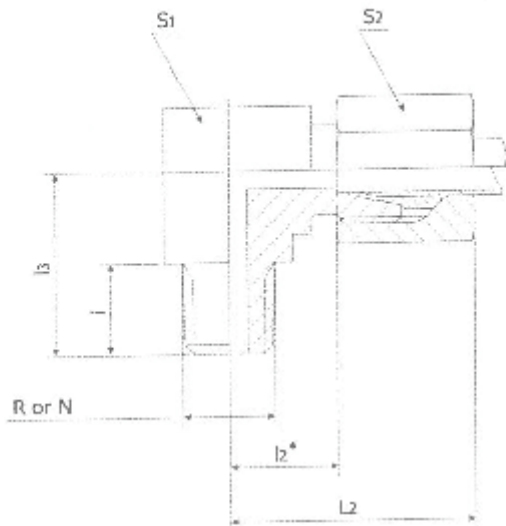

* refers to tube end

ELBOW MALE STUD BSPT/ NPT - TAPER

SPT	NOMINAL WORKING PRESSURE	TUBE O.D.	S1	S2	L2	l2	BSPT THD.			NPT THD.			WT. Kg/100 Pieces			
							R	i	l3	PART NUMBER	N	i	l3	PART NUMBER	R	N
L M E D I U M	250Kg/cm ²	6	12	14	27	12	1/8"	10	20	LEMS 06 RT	1/8"	9.9	20	LEMS 06 NT	4.8	4.8
		8	14	17	29	14	1/4"	14	26	LEMS 08 RT	1/4"	15.1	26	LEMS 08 NT	7.9	7.6
		10	14	19	30	15	1/4"	14	27	LEMS 10 RT	1/4"	15.1	27	LEMS 10 NT	10.0	9.8
		12	17	22	32	17	3/8"	14	28	LEMS 12 RT	3/8"	15.2	28	LEMS 12 NT	14.1	14.3
		15	22	27	36	21	1/2"	16	34	LEMS 15 RT	1/2"	19.8	34	LEMS 15 NT	15.6	16.8
	160Kg/cm ²	18	27	32	40	23.5	1/2"	16	36	LEMS 18 RT	1/2"	19.8	36	LEMS 18 NT	19.9	19.8
S H E A V Y	630Kg/cm ²	6	14	17	31	16	1/4"	14	26	SEMS 06 RT	1/4"	15.1	26	SEMS 06 NT	8.6	8.3
		8	17	19	32	17	1/4"	14	27	SEMS 08 RT	1/4"	15.1	27	SEMS 08 NT	10.6	11.4
		10	19	22	34	17.5	3/8"	14	28	SEMS 10 RT	3/8"	15.2	28	SEMS 10 NT	16.0	16.0
		12	22	24	38	21.5	3/8"	14	28	SEMS 12 RT	3/8"	15.2	28	SEMS 12 NT	19.8	20.2
		14	22	27	40	22	1/2"	16	32	SEMS 14 RT	1/2"	19.8	34	SEMS 14 NT	20.4	20.9
	400Kg/cm ²	16	24	30	43	24.5	1/2"	16	32	SEMS 16 RT	1/2"	19.8	36	SEMS 16 NT	21.5	22.3

PART NUMBER CODE

