

* refers to tube end

STRAIGHT MALE STUD **BSP-PARALLEL**

| S E R I E S | NOMINAL WORKING PRESSURE | TUBE O.D. | S1 | S2 | i | li | L1 | d | BSP THD G | PART NUMBER | WT. Kg/100 PIECES |
|-------------|--------------------------|-----------|----|----|----|------|------|----|-----------|-------------|-------------------|
| | | | | | | | | | | | |
| L | 250Kg/cm ² | 6 | 14 | 14 | 8 | 8.5 | 23 | 14 | 1/8" | LSMS 06 RP | 2.5 |
| | | 6 | 19 | 14 | 12 | 10 | 25 | 18 | 1/4" | LSMS 06 RPS | 4.0 |
| | | 8 | 19 | 17 | 12 | 10 | 25 | 18 | 1/4" | LSMS 08 RP | 4.5 |
| | | 10 | 19 | 19 | 12 | 11 | 26 | 18 | 1/4" | LSMS 10 RP | 4.7 |
| | | 10 | 22 | 19 | 12 | 12.5 | 27.5 | 22 | 3/8" | LSMS 10 RPS | 6.0 |
| | | 12 | 22 | 22 | 12 | 12.5 | 27.5 | 22 | 3/8" | LSMS 12 RP | 7.0 |
| | | 12 | 27 | 22 | 14 | 13 | 28 | 26 | 1/2" | LSMS 12 RPS | 9.5 |
| | | 15 | 24 | 27 | 12 | 14 | 29 | 22 | 3/8" | LSMS 15 RP | 9.5 |
| | | 15 | 27 | 27 | 14 | 14 | 29 | 26 | 1/2" | LSMS 15 RPS | 11.5 |
| M | 160Kg/cm ² | 18 | 27 | 32 | 14 | 14.5 | 31 | 26 | 1/2" | LSMS 18 RP | 13.2 |
| | | 22 | 32 | 36 | 16 | 16.5 | 33 | 32 | 3/4" | LSMS 22 RP | 18.5 |
| | | 22 | 41 | 36 | 18 | 17.5 | 34 | 39 | 1" | LSMS 22 RPS | 25.0 |
| I | 100Kg/cm ² | 28 | 41 | 41 | 18 | 17.5 | 34 | 39 | 1" | LSMS 28 RP | 25.9 |
| | | 35 | 50 | 50 | 20 | 17.5 | 39 | 49 | 1 1/4" | LSMS 35 RP | 42.2 |
| | | 42 | 55 | 60 | 22 | 19 | 42 | 55 | 1 1/2" | LSMS 42 RP | 57.2 |

PART NUMBER CODE

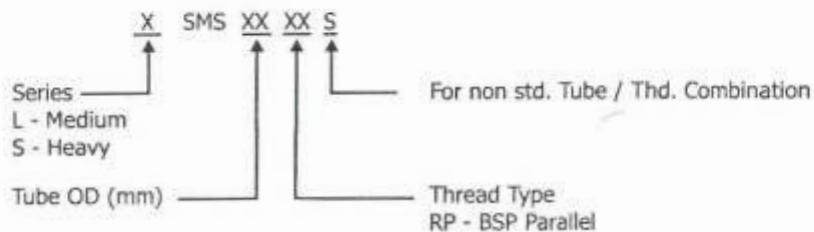

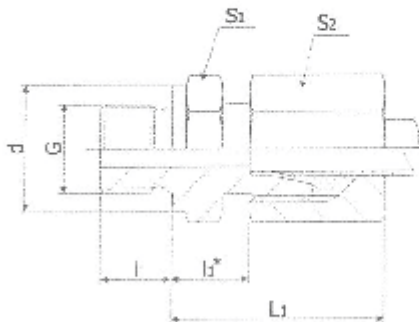

* refers to tube end

STRAIGHT MALE STUD **BSP-PARALLEL**

| S E R I E S | NOMINAL WORKING PRESSURE | TUBE O.D. | S ₁ | S ₂ | i | l ₁ | L ₁ | d | BSP THD G | PART NUMBER | WT. Kg/100 PIECES |
|----------------------------|--------------------------------|--------------|----------------|----------------|----|----------------|----------------|----|-----------------|----------------|-------------------------|
| | | | | | | | | | | | |
| S | 630Kg/cm ² | 6 | 19 | 17 | 12 | 13 | 28 | 18 | 1/4" | SSMS 06 RP | 5.0 |
| | | 8 | 19 | 19 | 12 | 15 | 30 | 18 | 1/4" | SSMS 08 RP | 5.5 |
| | | 10 | 22 | 22 | 12 | 15 | 31.5 | 22 | 3/8" | SSMS 10 RP | 8.6 |
| | | 12 | 22 | 24 | 12 | 17 | 33.5 | 22 | 3/8" | SSMS 12 RP | 10.0 |
| | | 12 | 27 | 24 | 14 | 17.5 | 34 | 26 | 1/2" | SSMS 12 RPS | 13.5 |
| | | 14 | 27 | 27 | 14 | 19 | 37 | 26 | 1/2" | SSMS 14 RP | 14.8 |
| H E A V Y | 400Kg/cm ² | 16 | 27 | 30 | 14 | 18.5 | 37 | 26 | 1/2" | SSMS 16 RP | 16.1 |
| | | 20 | 32 | 36 | 14 | 18.5 | 41 | 26 | 1/2" | SSMS 20 RPS | 25.3 |
| | | 20 | 32 | 36 | 16 | 20.5 | 43 | 32 | 3/4" | SSMS 20 RP | 25.3 |
| | | 25 | 41 | 46 | 16 | 21 | 45 | 32 | 3/4" | SSMS 25 RPS | 46.0 |
| | | 25 | 41 | 46 | 18 | 23 | 47 | 39 | 1" | SSMS 25 RP | 46.5 |
| H E A V Y | 250Kg/cm ² | 30 | 46 | 50 | 18 | 23.5 | 50 | 39 | 1" | SSMS 30 RPS | 61.5 |
| | | 30 | 50 | 50 | 20 | 23.5 | 50 | 49 | 1 1/4" | SSMS 30 RP | 63.5 |
| | | 38 | 55 | 60 | 20 | 26 | 57 | 49 | 1 1/4" | SSMS 38 RPS | 85.0 |
| | | 38 | 55 | 60 | 22 | 26 | 57 | 55 | 1 1/2" | SSMS 38 RP | 87.0 |

PART NUMBER CODE

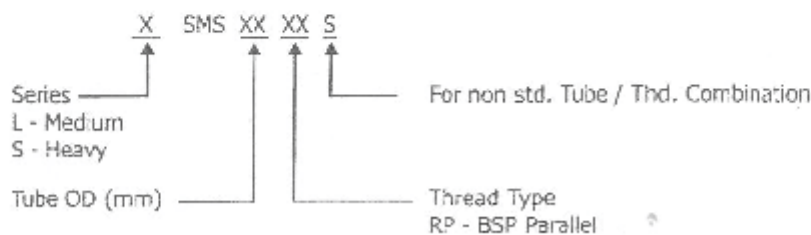

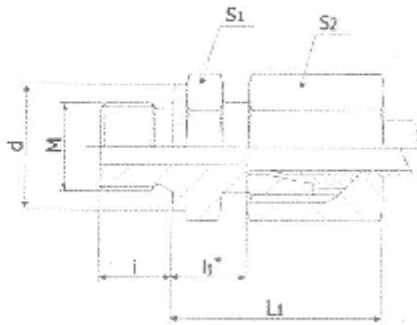

* refers to tube end

STRAIGHT MALE STUD METRIC-PARALLEL

| SIZES | NOMINAL WORKING PRESSURE | TUBE O.D. | S1 | | S2 | | i | | li | | L1 | | d | METRIC THD M | PART NUMBER | WT. Kg/100 Pieces |
|---------------------------------|--------------------------|-----------|----|----|----|------|------|----|---------|------------|------|--|---|--------------|-------------|-------------------|
| | | | | | | | | | | | | | | | | |
| L M E D I U M | 250Kg/cm ² | 6 | 14 | 14 | 8 | 8.5 | 23 | 14 | M10x1 | LSMS 06 MP | 2.5 | | | | | |
| | | 8 | 17 | 17 | 12 | 10 | 25 | 17 | M12x1.5 | LSMS 08 MP | 4.0 | | | | | |
| | | 10 | 19 | 19 | 12 | 11 | 26 | 18 | M14x1.5 | LSMS 10 MP | 4.9 | | | | | |
| | | 12 | 22 | 22 | 12 | 12.5 | 27.5 | 22 | M16x1.5 | LSMS 12 MP | 7.0 | | | | | |
| | | 15 | 24 | 27 | 12 | 13.5 | 28.5 | 24 | M18x1.5 | LSMS 15 MP | 9.5 | | | | | |
| | 160Kg/cm ² | 18 | 27 | 32 | 14 | 14.5 | 31 | 26 | M22x1.5 | LSMS 18 MP | 13.2 | | | | | |
| | | 22 | 32 | 36 | 16 | 16.5 | 33 | 32 | M26x1.5 | LSMS 22 MP | 18.8 | | | | | |
| | | 28 | 41 | 41 | 18 | 17.5 | 34 | 39 | M33x2 | LSMS 28 MP | 25.9 | | | | | |
| | 100Kg/cm ² | 35 | 50 | 50 | 20 | 17.5 | 39 | 49 | M42x2 | LSMS 35 MP | 42.2 | | | | | |
| | | 42 | 55 | 60 | 22 | 19 | 42 | 55 | M48x2 | LSMS 42 MP | 57.0 | | | | | |
| S H E A V Y | 630Kg/cm ² | 6 | 17 | 17 | 12 | 13 | 28 | 17 | M12x1.5 | SSMS 06 MP | 4.7 | | | | | |
| | | 8 | 19 | 19 | 12 | 15 | 30 | 18 | M14x1.5 | SSMS 08 MP | 6.5 | | | | | |
| | | 10 | 22 | 22 | 12 | 15 | 31.5 | 22 | M16x1.5 | SSMS 10 MP | 8.6 | | | | | |
| | | 12 | 24 | 24 | 12 | 17 | 33.5 | 24 | M18x1.5 | SSMS 12 MP | 10.9 | | | | | |
| | | 14 | 27 | 27 | 14 | 19 | 37 | 26 | M20x1.5 | SSMS 14 MP | 14.8 | | | | | |
| | 400Kg/cm ² | 16 | 27 | 30 | 14 | 18.5 | 37 | 26 | M22x1.5 | SSMS 16 MP | 16.1 | | | | | |
| | | 20 | 32 | 36 | 16 | 20.5 | 43 | 32 | M27x2 | SSMS 20 MP | 25.3 | | | | | |
| | | 25 | 41 | 46 | 18 | 23 | 47 | 39 | M33x2 | SSMS 25 MP | 46.5 | | | | | |
| | 250Kg/cm ² | 30 | 50 | 50 | 20 | 23.5 | 50 | 49 | M42x2 | SSMS 30 MP | 63.5 | | | | | |
| | | 38 | 55 | 60 | 22 | 26 | 57 | 55 | M48x2 | SSMS 38 MP | 87.0 | | | | | |

PART NUMBER CODE

